

PIERSON RANCH RECREATION AREA

District Headquarters at Lewis & Clark Recreation Area
 43349 SD Hwy. 52, Yankton, SD 57078 - (605)668-2985
 Camping Reservations: www.campsd.com or 1-800-710-CAMP (2267)
 email: Lewis-Clark@state.sd.us - www.lewisandclarkpark.com

To Yankton and US 81 →

← To Lewis and Clark Recreation Area and SD 50

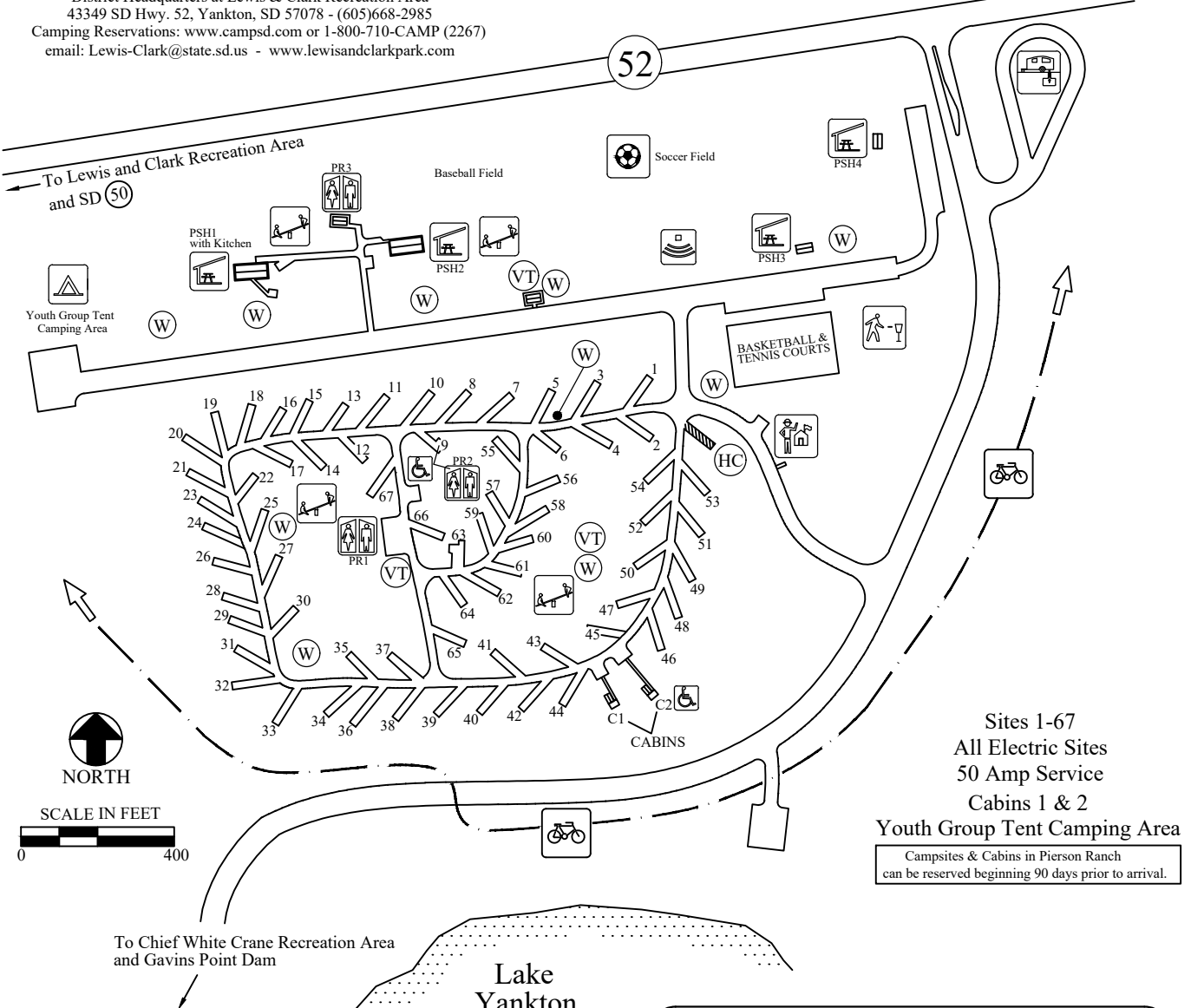

Sites 1-67
 All Electric Sites
 50 Amp Service
 Cabins 1 & 2
 Youth Group Tent Camping Area
 Campsites & Cabins in Pierson Ranch
 can be reserved beginning 90 days prior to arrival.

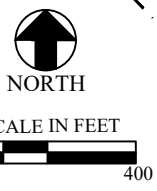

RECREATION OPPORTUNITIES AND PARKS FACILITIES KEY

	COMFORT STATION		CAMPGROUND		HIKING TRAIL		PLAYGROUND
	ACCESSIBLE FACILITIES		PICNIC AREA		ENTRANCE STATION		DUMP STATION
	DISC-GOLF		PICNIC SHELTER		AMPHITHEATER (PARK PROGRAMS)		ACCESSIBLE FISHING DOCK
	SOCCER GOALS		BIKE TRAIL		BASKETBALL COURT		
	VAULT TOILET		HOST CAMPSITE (NON-RESERVABLE)		DRINKING WATER		