

Lake Louise Recreation Area Trail System

INFORMATIONAL PLAQUES AND STATIONS

- | | | |
|-------------------------------------|--|---|
| 1. POEM | 12. SUMAC | 26. HONEY LOCUST TREE |
| 2. LAKE CHARACTERISTICS | 13. ISLAND OUTLOOK | 27. "YOU" |
| 3. WATER WILLOW | 14. NEW HORIZONS | 28. CRESTED WHEAT GRASS |
| 4. COTTONWOOD | 15. SILVER MAPLE | 29. RING NECKED PHEASANT |
| 5. FOXTAIL BARLEY | 16. BIRD WATCHER'S PARADISE | 30. PLUM THICKET |
| 6. COMMON GARTER SNAKE | 17. PLUM THICKET | 31. BLUEBIRD NESTING BOX |
| 7. FOLDING BRIDGE | 18. TRAIL AND TERRAIN FEATURES | 32. OYSTER PLANT |
| 8. CATTAILS | 19. MILKWEED | 33. EASTERN RED CEDAR |
| 9. LAKE LOUISE GAME PRODUCTION AREA | 20. COCKLEBUR | 34. PONDEROSA PINE |
| 10. MARSH HABITAT | 21. LAKE LOUISE | 35. WILD ROSE |
| 11. DECOMPOSITION | 22. HIKING & SKIING | 36. HONEYSUCKLE SHRUBS |
| | 23. WEST CAMPGROUND HISTORIC WELL AND PLAQUE | 37. WEeping WILLOW TREE |
| | 24. AQUATIC WILDLIFE | 38. RUSSIAN OLIVE TREE |
| | 25. MOURNING DOVE | 39. HISTORIC SITE-- INDIAN BURIAL GROUNDS |
| | | 40. FLOWERING ROCKETS |

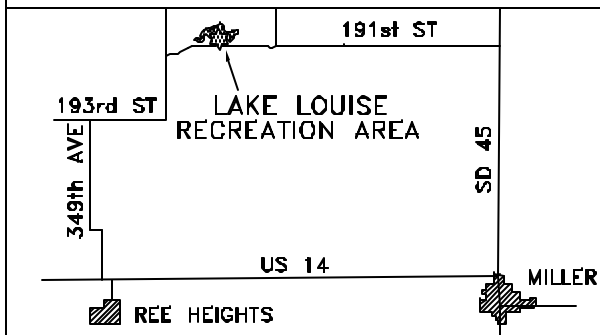
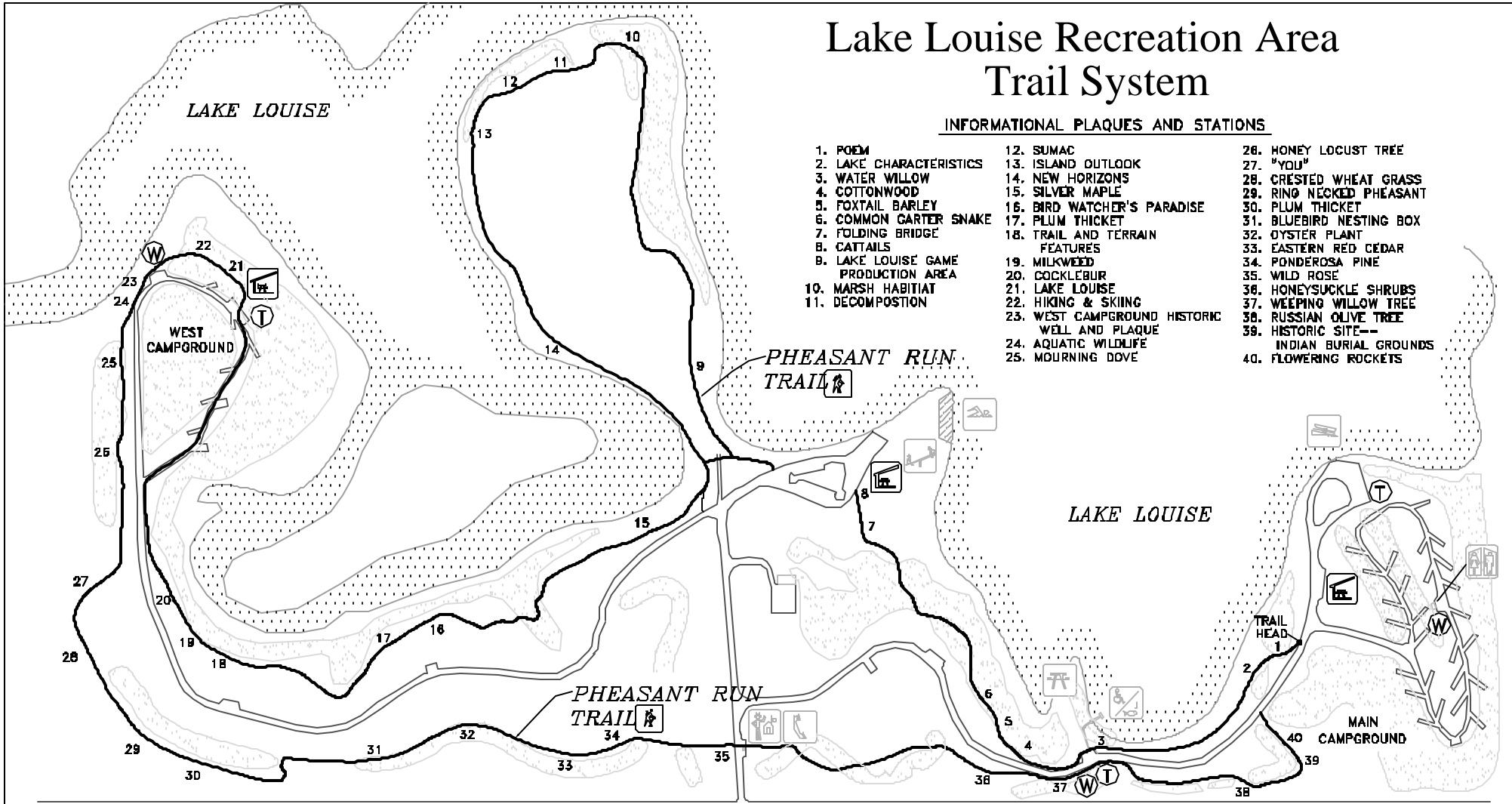

SCALE IN FEET



Date: 7/01/02

Lake Louise Recreation Area

Pheasant Run Trail

Type of trail: Hiking and interpretive/viewing nature

Trail surface: Dirt and grass

Rated: Easy, appropriate for all ages

Fee required: Park Entrance License

Length of trail in miles: 3.2 miles

Location of the trailhead: Near entrance to campground

Facilities at or near the trailhead: Campground

Facilities along the trail: Toilet, drinking water, bench, picnic table, pay phone – trail runs through park

Will there be interpretive information available: Yes

What lodging opportunities are provided IN the park: Tent camping, electrical and non-electrical campsites, wheelchair accessible campsite, camping cabins

Does this trail connect with any other trails: No

Nearest facilities for purchasing snacks, sunscreen etc.: In Miller – 14 miles

Nearest motels/restaurants OUTSIDE the park: In Miller – 14 miles

Name, address, and phone numbers of nearest Chamber of Commerce:

Miller Chamber of Commerce, (605) 853-3687

Emergency phone numbers:

Ambulance - 911

Sheriff - (605) 853-2408 or 911

Fire Department - 911

Do most cell phones work on this trail: Cell phones may not work on the trail