

**ADDENDUM NO. 2**  
**May 18, 2018**

Maintenance Building  
Webster Office Complex  
Day County, South Dakota  
GFP Project No. Webs18Wa

Bid Opening Date: May 22, 2018, 3:30 PM CT  
Department of Game, Fish and Parks  
2nd Floor, Foss Building  
523 East Capitol  
Pierre, South Dakota 57501-3182

Owner: State of South Dakota  
Department of Game, Fish and Parks

Scope of this Addendum:

The following becomes a part of the original plans and specifications, taking precedence over the items that may conflict. The bidder shall note receipt and make acknowledgment of the addendum on his bid form, incorporating its provisions in his bid.

- Item No. 1: Change to Panel "A" Layout on Sheet E1: See Attached Plan Sheet
- Item No. 2: Change to Electrical Outlet Layout: See Attached Plan Sheet
- Item No. 3: CLARIFICATION: Underground Electrical Service Layout: See Attached plan Sheet

May 18, 2017

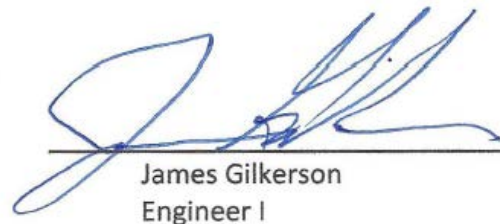

James Gilkerson  
Engineer I

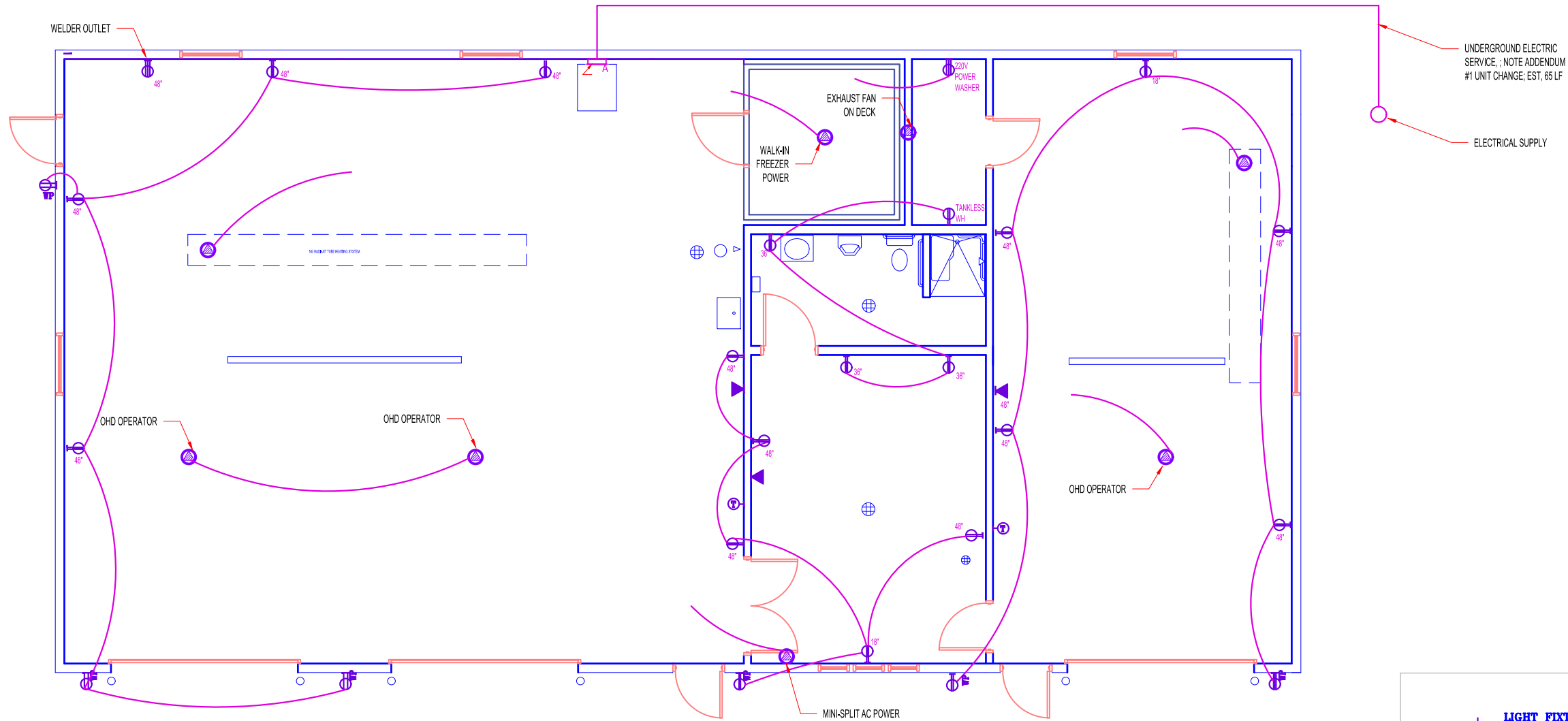

## ELECTRICAL POWER PLAN

SCALE 1/8" = 1'

PANEL "A" SURFACE MOUNT 225 AMP MAIN & MAIN BREAKER NEMA 1 ENCLOSURE BOLT ON BREAKERS									
120 / 240 / 1φ / 3 WIRE									
LOAD	P	CIR BKR	CIR NO	PH	CIR NO	CIR BKR	P	LOAD	
OUTLETS EAST	1	20	1	A	2	20	1	OTLETS WEST	
OUTLETS EAST	1	20	3	B	4	20	1	OUTLETS STORAGE/LAB/BATH	
LIGHTS EAST	1	20	5	A	6	20	1	LIGHTS WEST	
LIGHTS EAST	1	20	7	B	8	20	1	LIGHTS LAB/BATH	
OHD EAST	1	20	9	A	10	30	1	HEAT LAB/BATH	
WALK-IN-FREEZER	1	20	11	B	12	20	1	RADIANT HEAT WEST	
RADIANT HEAT EAST	1	20	13	A	14	20	1	EXHAUST FAN	
OHD WEST	1	20	15	B	16	30	2	STORAGE POWER WASH	
SPARE	1	20	17	A	18				
SPARE	1	20	19	B	20				
WELDING OUTLET	2	50	21	A	22	20	2	MINI-SPLIT	
			23	B	24	20	1	SPARE	

- LIGHT FIXTURE (lower case letter indicates switching)
- WALL MOUNTED LIGHT FIXTURE (upper case letter indicates fixture type)
- LIGHT FIXTURE
- SINGLE CONVENIENCE OUTLET
- DUPLEX CONVENIENCE OUTLET
- GFI DUPLEX CONVENIENCE OUTLET
- WELDER OUTLET
- SPECIAL OUTLET
- WEATHERPROOF DUPLEX OUTLET
- TELEPHONE OUTLET
- DISCONNECT SWITCH
- THERMOSTAT
- SINGLE POLE SWITCH
- THREE WAY SWITCH
- FOUR WAY SWITCH
- SWITCH (lower case letter indicates fixture switching)
- MOTOR CONNECTION
- CONDUIT SEAL
- HOME RUN TO PANEL (letter-panel,number-circuit breaker)